

(91) 58

C12? big entrance, on the right side of big fault (N-S) visible from long distance, 10 m drop, next 15 m drop on the snow, must be connected to C9; ~ 200 m lower than C9

31/07/94 Alex and Harvey

We set off intending to drop F24 & F27 but we were distracted by a herd of 20-30 rebekahs on the far side of the valley we decide to drop a shaft Alex had found on a previous walk. Instead we found F48 which hadn't been bottomed so Alex gingerly crossed the snow plug and entered the rift. He reached the chamber described in the shaft bashing guide and came back for an oversuit, rope and SRT kit. Fully equipped he plunged back into the cave and followed the rift to a series of climbs down to a pitch head, ~~was~~ this is probably what is referred to by 'the team ran out of rope'. The pitch was rigged off a boulder and a flake with a take off so low that it would turn Tim green with envy. The pitch is 10-12m deep. The rift descends down a series of free climbs. The rift closes down after 10 minutes. There is a possible way on slightly higher in the rift but this closes down to an 10cm wide slot which could be hammered open as the rift widens slightly beyond, the streamway below looks quite wide if it were possible to drop down beyond the squeeze, however without a hammer and a call out to make I turned around and started the free climbs back up to the pitch, detached and lugged the equipment out, arriving at 5 seconds to five (Harvey was allowed to get worried at five) and walked back to camp.

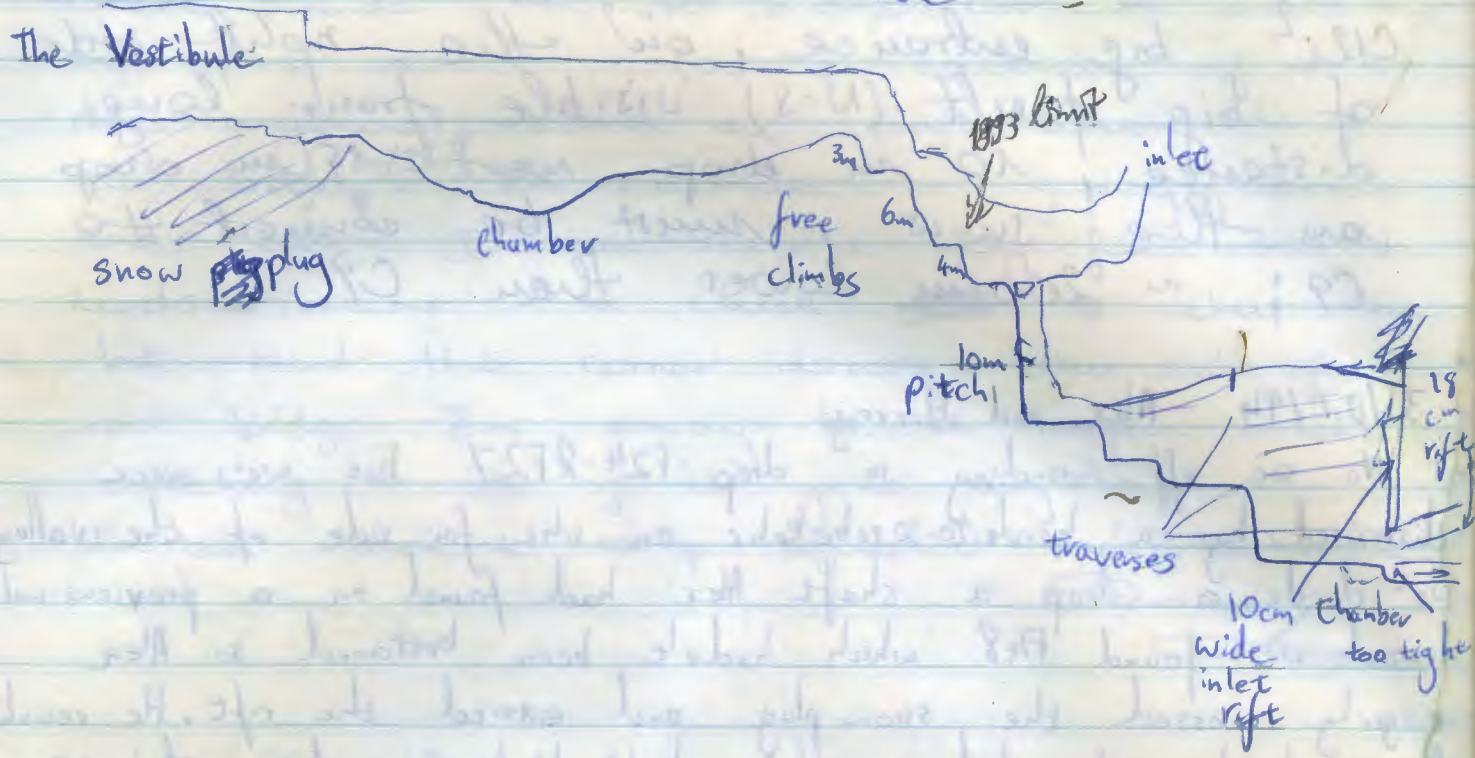

FG4

John & Gavin

1/8/94

Continued rigging from the previous limit. Bolt 1-hanging for 5m drop followed by bolt deviation for further 5m descent. Immediately there was yet another 5m drop, rigged off 2 bolts. It's possible to climb down the rift at this point, but we traversed forward to a short drop into a chamber, where the passage suddenly changes direction, heading roughly NE (previously it's been going NNW). Also the draught changes direction, blowing out of the cave whereas previously it has been blowing down. This suggests that another cave drops in here which takes the draught out. Descended a 25m pitch (which needs some re-rigging) to the top of a pitch of about 20m.

After sharing a tent with James Dave says - "I'm not geriatric, just prematurely triggered."

31/7/94 - 1/8/94

Mick & Dave go on a 'jolly' to the bottom of C9 to check if Mick can get there & back - Take car. Brilliant, wonderful, amazing trip. We did the morning survey legs on Dirt Drive, Dave re-rigged the bagging relay (a place ~~where~~ where Mick spent quite some time trying to reach a foot loop jammer to unclip the wedged thing, spinning gently in place) & we even fished about at the end looking for leads - found nothing - a loop below the first rope - ^{with right} Dave climbed up, Mick grovelled through boulders, a mat or white mud-slope in the middle. Possible dig on the left didn't look promising. Dave climbed into holes half-way up the rope, found a place to hammer but it just goes into the big boulder chamber. One potential lead - a climb after short traverse up left hand side of boulder chamber. Dave didn't like the climb & Mick wasn't even here on the traverse & set on "stable" floor which turned out to be a thin layer of chon. Energy at 5am, Mick can no longer criticize the Curatis doing overnight trips. Then a pair of geriatrics ate dinner/breakfast & walked the down from the hill above Top Camp.

One final thing - Mick has finally discovered something she hates more than water in caves - Rodden's hideous water-avoiding rope loops, designed for goblins who specialise in one armed pull-ups.

ONE MINOR POINT - Team 769 - Gav & John did NOT tick themselves off for their midnight callout on 31/7 so team geriatric - after C9, not knowing anyone had walked up - till James quizzing test spoke - & believing Sharon to be the only person in camp were reluctantly contemplating a slow motion rescue. Dark scene in like that - the idea of NOT coming was terrifying.

2/8/94

Alex, Steve

C10 ⊗

Grade 2 survey:-

Extended elevation

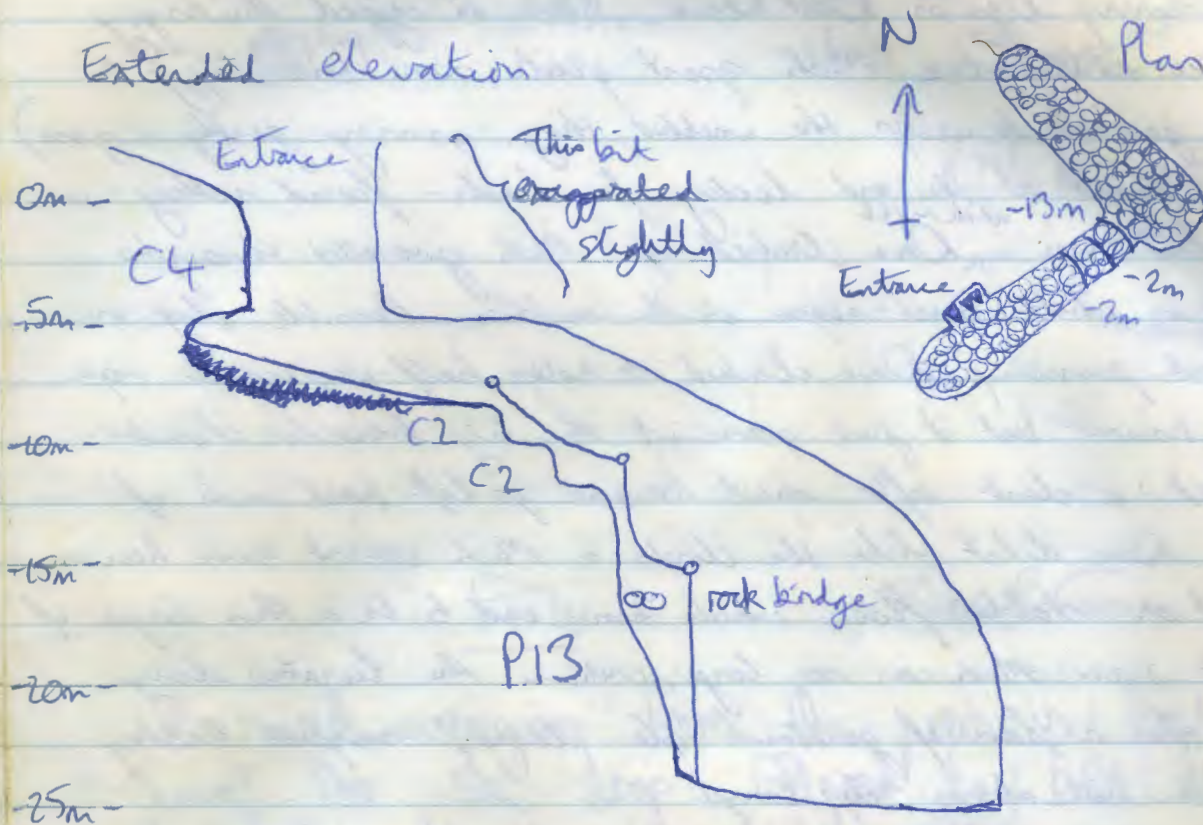

Description: Small slit in surface rift, 2m x 0.75m, leads after 4m climb down to small chamber with loose, bouldery floor. Heading left, two 2m climbs down lead to head of 13m pitch. Bolt in left-hand wall at top of first climb is start of traverse to pitch head. Descending pitch (bolts on left-hand wall at 0m and -5m) leads to well-decorated oven (moor milk, popcorn) with bouldery floor but no way on.

No discernible draught, but some air movement could be felt due to gusts of wind on the surface.

The first trip to find a bottom entrance to C9; unfortunately this was not to be it.

2/8/94

Steve

Shaft bashing

F72 ⊙

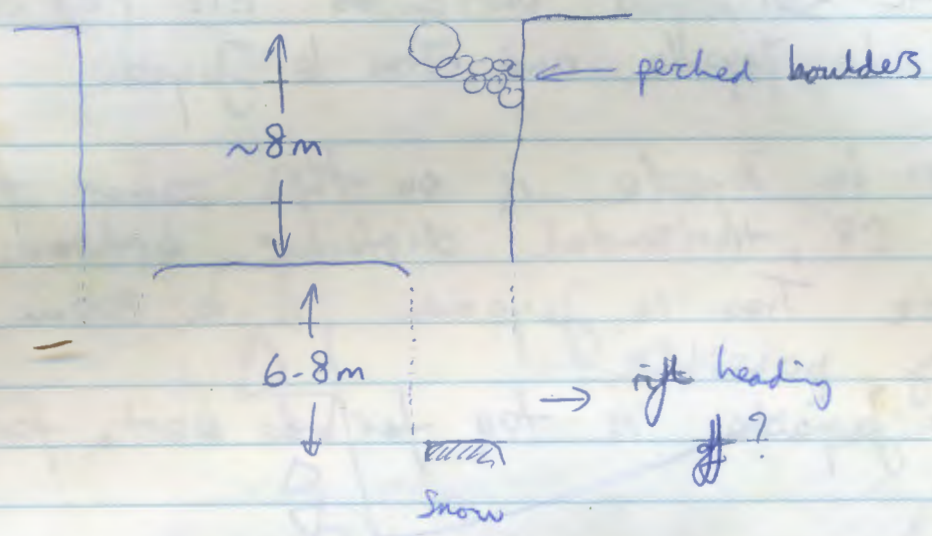

F69 ⊗

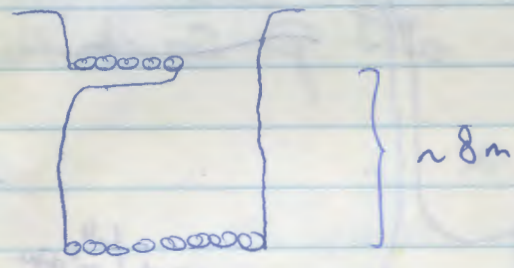

8m climb down through 1m wide rift to bouldery floor. No way on.

Dave: "I notice that the incredible melting man vanished"

4/08/94 Horthy & Wodelek

1. We surveyed entrances C12 (C7, C8, C9, C10, C11) and Las Joyas and Tres le Jayas

Tres le Jayas is on this same fault line as C9, horizontal distance between end of C9 and Tres le Jayas is ca 300m, connecting is very possible. Le Jayas is too far to east, for connection

2. On the way back to Top Camp we found very interesting cave without marks on the slope of ~~P. Gustatory~~ ^{the} Regellón

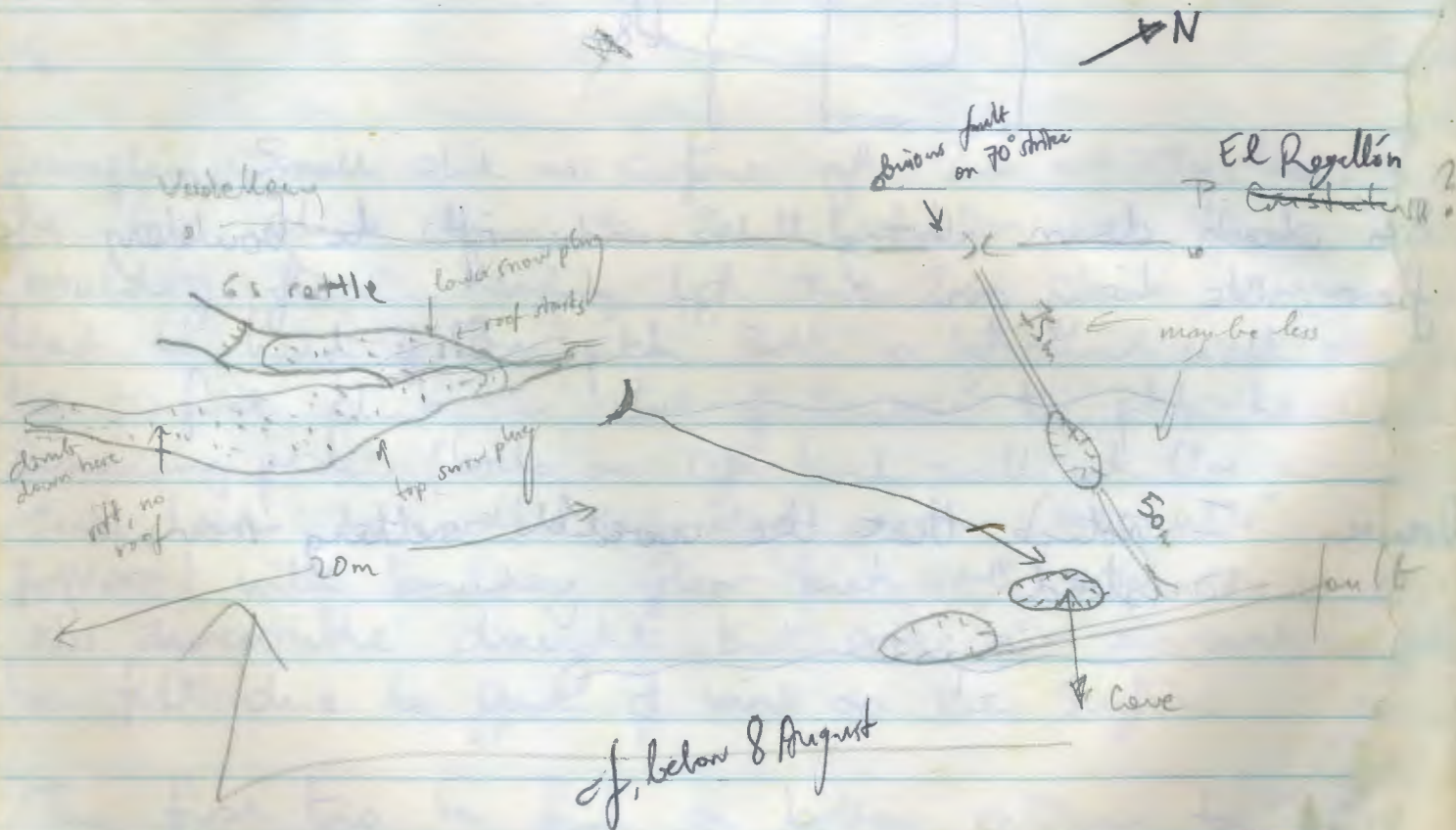

2/08/94

C9 Spiderman's Return

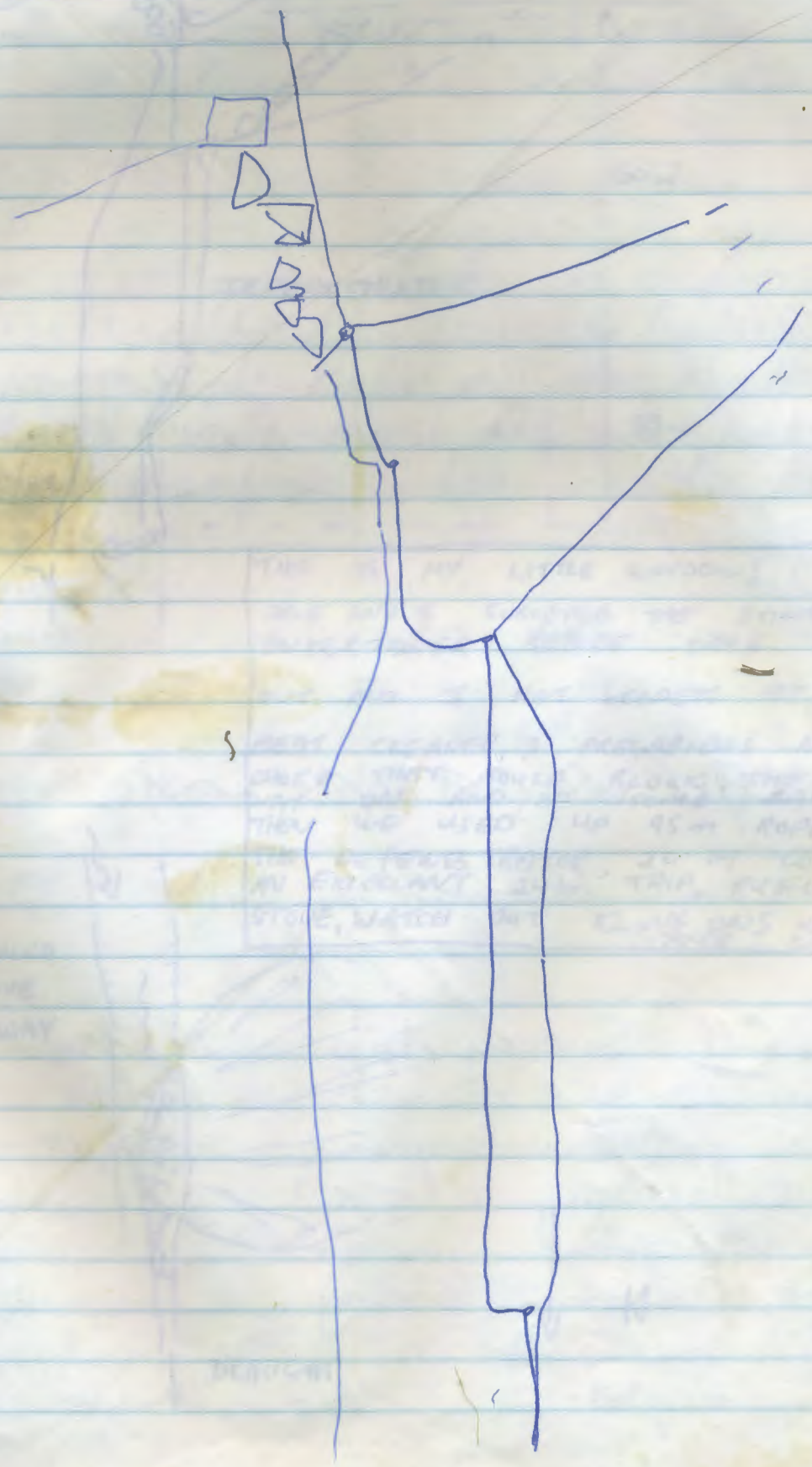

fold along the creases to make your own helictite.

11/18/19

The distance between the two points is 2.0 cm. The distance between the two points is 2.0 cm. The distance between the two points is 2.0 cm.

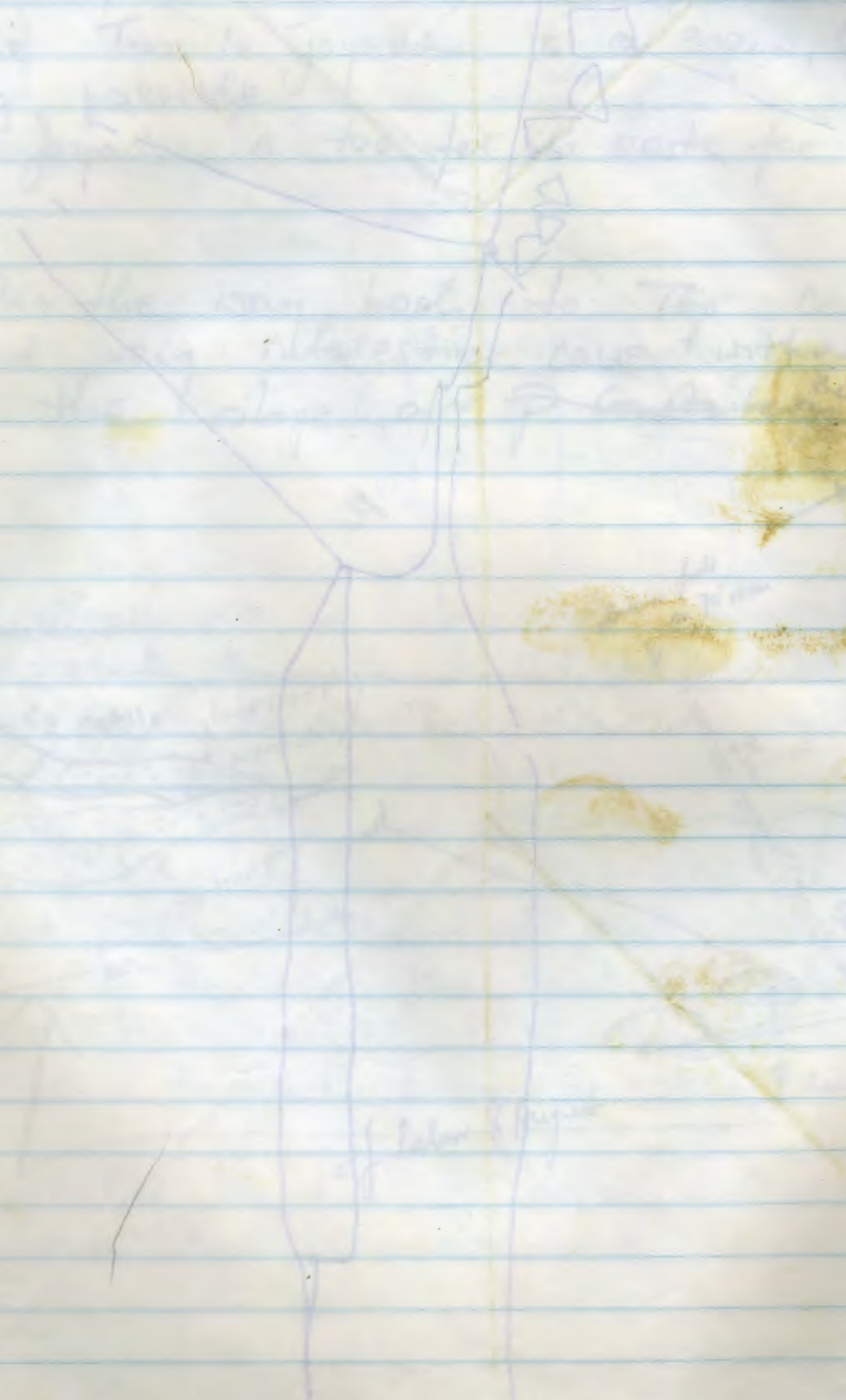

On the way back to the... the distance between the two points is 2.0 cm.



WLODER & JAMES

SPIDERMAN'S RETURN

2/08/84

TERMINATOR 3

W-E PROJECTION

GRADE 1

0
20
40
60
80
100
120
140

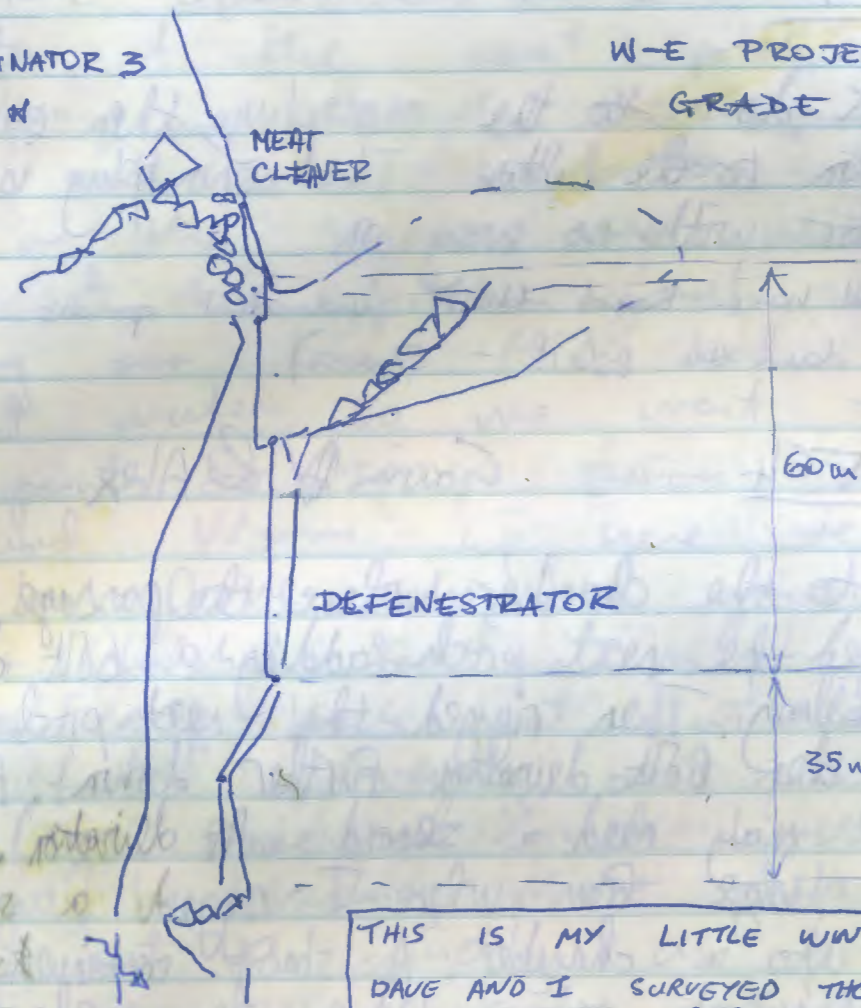

THIS IS MY LITTLE WINDOW!
 DAVE AND I SURVEYED THE STINK AND ENTERTAINER BEFORE DAVE WENT OUT AND I MET WLODER AT THE MEAT CLEAVER, A PRECARIOUS BOULDER CHOKER THAT COULD BLOCK THE ONLY WAY ON AND DO SOME DAMAGE. THEN WE USED UP 95M ROPE ON THE DEFENESTRATOR, 20M TO BOTTOM AN EXCELLANT 24hr TRIP, BUT OVER THE STOVE, WATCH OUT KLING ONS WE'RE ON YOUR CASE.

UNDERGROUND OVERDRIVE STREAMWAY

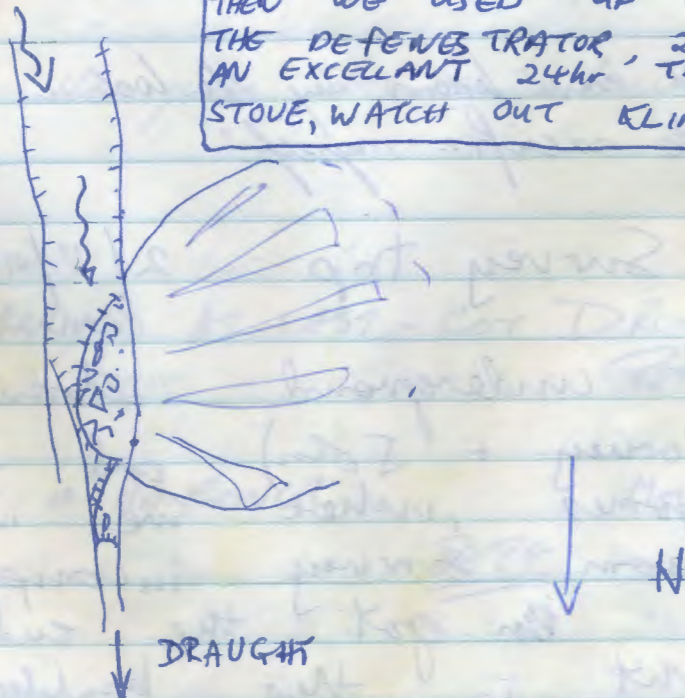

DRAUGHT

F70 (Steven, Gavin, Sharon)

3/8/94

Steve went down to the snowplug, then came out. I went down to the bottom. The snowplug is resting on the floor with no way on.

(ooo, you should have heard their individual opinions when the one was down the hole! - Sharon)

F64

Gavin & Alex 4/8/94

Surveyed to the chamber where the passage turns ~~right~~. Rerigged the next pitch, adding a bolt deviation and bolt relay. Then rigged the next pitch - 2 bolts for Y-hang, then bolt deviation further down. Pitch is $\sim 30m$, and may need a second bolt deviation. This lands on a ledge from where I rigged a short pitch down into a chamber. A shaft continues - it looks like $\sim 20m$ to a ledge, then another 4 second rattle.

Don Survey Trip 2/8/94 - 3/8/94

Harvey "I should have known by the look in Don's eyes, I didn't need to sacrifice myself."

C9 Survey trip

2/8/94 - 3/8/94

We got underground about midday (Midge, Harvey & John) and soon got to right games, where we immediately became team Sweeney incompetent. First we got the end of the rope caught in the boulder choke,