

Shafting in area 12 - Gavin 15/7/92

Went over Julagwa ridge and found cave 5 minutes down the Culienbro path, 27/14, just to the (R) of the path, a shaft with a beach tree in, marked SIE (X). Looks to be 10-15m to a snow plug.

Continued to Oston. I don't think I saw 1/12 (at least I didn't see anything meeting its description). Continued down the Culienbro path and found two caves in the left hand cliff:

6/12 obvious large entrance in cliff at altitude of about 800m. Chokes immediately. This might be 3/12

7/12 A bit below 6/12, another large entrance. This has an artificial rock stair case leading up to it, and a wooden fence across the entrance. ^{This also might be 3/12} This also chokes immediately.

I then spotted an entrance above me, and so climbed up to it - hard work with tufts of grass for hand holds and a wade through nettles at the top. Chokes immediately.

This is 8/12. Followed a goat path off and got back to the top of the Culienbro path, where I had been 1/2 hour previously. [Directions for finding 8/12: Follow the Culienbro path from Oston (I think there are 2 of these; you want the higher one) where it starts zig-zagging down the valley, go straight on at the first bend and follow a goat track round onto the ribs. Climb down and continue travelling downwards to meet a narrow and exposed goat track round the edge of the ribs to suddenly arrive at the cave.]

Decided I couldn't be bothered to go back down, so went back to Oston. Checked out two caves visible from here:

9/12 triangular entrance 3m high, 1-5m wide at same height as Oston. Bearing ~50° to Oston. Chokes immediately

10/12 About 40m above 9/12. Large entrance under

(22)

overhang with fir tree in entrance. Large chamber with artificial walls at back. Crawl at back chokes immediately. Climb to (R) leads to 2nd chamber with 10cm wide continuation.

Nearly a **RESCUE** but not quite

Sean & Pauline's call out time 21.00
Time now 21.01

The plan: Gavin to go and try to find out what the problem is, taking rescue kit (SRT bag)

If no contact is made within 20 minutes then Dave will phone base, and follow bringing baby bouncer and splints from the stretcher, ~~and~~ any bandages he can find, and anything useful from the rescue kit (Daren Drum)

Anyone else should follow as soon as possible

They are either in 9/4 or a new cave located over the ridge and follow the Culembro path for 5 minutes - cave on RHS of path with beech tree growing in it.

21.05 Joan arrives, situation explained to her

21.06 Gavin leaves camp

Decision made not to phone base as there's only

one person there

21.15 no sign of them at new cave

21.21 Sean and Pauline spotted near 9/4. No apparent problems so Gavin returns to stand down rescue

21.30 Joan and Dave notified

21.37 Rescuers return to base

21.38 Tea put on

21.58 Sean and Pauline arrive back, saying their callout time was midnight

Points arising:

- 1) THERE SHOULD BE A FIRST AID KIT IN AN AMMO CAN AT ARIO FOR USE IN RESCUES
- 2) Occasional false alarms are a good thing as they make everyone learn the rescue procedure and highlight any short falls in rescue arrangements. (see point 1)
- 3) If we had another radio then it would be a good thing if the first person to go to look for them took a radio, and another radio was taken to a suitable place (in this case the Cabeza Julagua ridge).
- 4) Call out times should be written in the book.

If you have any comments about the above rescue procedure, please write them overleaf.

(24)

El Jese has not written a call out time in the book, so I hope he doesn't want rescuing tonight.

9/4 15/16/7/92 Sean + Pauline Shaft Bashing

The ~~left~~^{right} hand shaft at the bottom of the first pitch was rigged on a ladder, which only just reached with a 25' ladder. A 45° sloping floor covered with snow leads on for 30m, with several possible leads off up some of the walls. The end chokes, but we found a drafting hole on the right and spent a few hours digging a person sized opening in the floor. There seem to be no shiver raps on, but 9/4 could be worth another look later on. Derrigged the cave and brought all the gear back to Ario.

Sean

9/7 15/7/92

- ① Chris, Sam & David walk to 2/7, short of carbide
- ② David finds he left his furry suit at Ario
- ③ Chris & Sam go caving, David goes to Ario
- ④ David eats lunch (fried onion rings) & drinks tea.
- ⑤ David goes back to 2/7 with some carbide
- ⑥ David goes down 2/7 & meets Sam hanging on a deviation @ Armageddon.
- ⑦ David, Sam & Chris leave 2/7, get back at 00:35 ps. We carried 90m of rope to Armageddon (well, they did)

David

Rigging guide for 9/4

Entrance pitch	P18	25m rope	bolt on left, wire on right, back up to boulder
2nd pitch	P9	9m ladder, 20m lifeline	wire round spike at floor level

I include this rather brief guide because it may be worth going back to 9/4, although we have derigged it. Our dig definitely drafts ~~it~~. Also there is a lead we have not followed up. The chamber at the bottom of the ladder zig zags, first left, then right, then left, then right, and stops. On the outside of the 2nd L.H. bend is a climb ~4m with an uninvestigated hole at the top.

*and because it pleased me to ~~rig~~ write it. However keep in mind that most things in Area 4 are chucked before too long.

While I was digging Sean went off to change his battery, by then rather dim. At the bottom of the ladder it ran out. So he climbed the ladder and changed his battery in the dark. What else would a sensible person do in the circumstances?

← Sean of the battery? Both I think.

17/7/92

David has written a message in the Base Camp logbook. Please read it. The main points are:

- ① Bring the big tent to Ario
- ② Move ALL the other tents at Ario & Base Camp. (See under Davenport's tent for an explanation.)
- ③ Point ① at Base has been done (more or less). Well done Guy.

(26) I want to make a few points about the organisation of the Arvo camp.

- 1) The food tent has been getting overcrowded, so I've moved a lot of stuff into the shelter. Don't put food that is going to be damaged if it is rained on in the shelter. Also there isn't really room in the food tent for personal gear.
- 2) There are 5 loo rolls at 15/5: please don't take any more.
- 3) There are some coffee filters that fit inside the funnel for filtering water through so as to remove bad poles. They do their job but only allow water through slowly so the funnel overflows. Using a filter it probably takes an hour to fill a large container.
- 4) The spring is getting slower and Arvo is getting busier so we should be careful to ensure that we always have an adequate ^{reserve} supply of water.
- 5) If you are guarding a camp, it is your duty to make sure it is tidy and all the washing up is done. Having a day off caring is not an excuse to be a lazy slop.

17/7/92 2nd Camping trip started underground at ~1:00 pm with Sean laying wire for the radio-telephone and Sam, Dave & David following. Paul was taking people & entrance pictures and Chris was remaining to work surface radio. Radio worked at bottom of first pitches and again at 7th Heaven but their voice was quite faint, while they could hear me very loudly. So Sean put his radio in some water and asked if "that makes my transmission any louder?". It did in fact, but

It was the last thing I heard from him. Later I picked up a Spanish radio station (classical music). Waited til 4:45 pm to see if they could sort out the problem - but no response. Walked back down by contouring up and around Curicenter and down the western ridge of the Jon del Tultayn bowl. Passed by 4/7 whose location description should be changed (see back pages) and then passed 20/4, 25/4 + 24/4 low down near to Bayeya Col. Found small shaft apparently un-noticed, 40m from Bayeya Col reached by following sheep path to SW. Looked to be ~20m deep with bouldery bottom with undercut bottom which stones bounced into. Continued down trail finishing off cairn repairs so trail up to 2/7 is now well cairned the whole way.

Chris

Sunday 18/7/92

Notes on the Ario Base radio - The Ario unit is dickie.

I found that I could get :-

- ① Quiet noises
- ② Loud crackley noises

With ① you get very very faint + clear base reception

With ② you get loud slightly fuzzy reception.

You get ① all the time unless

You wiggle the aerial and then with the box tilted aerial end upwards @ $\approx 10^\circ$ and then you quite obviously get ②.

Therefore appeared to be a bad connection either in the end of the aerial or in the transmitter itself, but not with the batteries or battery swap over switch.

John

(23)
8/11 - The Story Goes On...

Poul
Steve

3 hr trip.

8/11 is now over 60m deep, with a further 8m undescended pitch - well worth scrambling.

However - if you want to go down, you'll have to rig it - I suggest for S.R.T., using the drill. Surveying also ought to be done - including the inlets.

Cave description & trip description.

We found the cave, a good start; this is how to do it :-

- i) Walk to refugio
- ii) Walk over ridge to right - following cairned path
- iii) Strike to right of depression, and over ridge behind
- iv) Drop down ridge, off the path, to gravelly striking into valley, cave caverns tree.

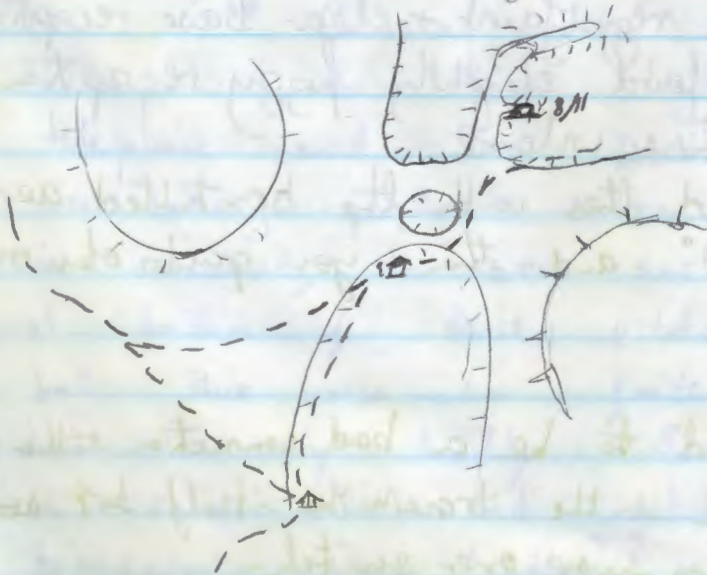

We got changed (I'll spare you the details)
We went down the coule,

I free climbed the first pitch, which has
a rope rigged on it for S.R.T.
(Natural baches above the coule entrance, to bolt
~~at~~ below. Wide deviation half way down pitch,
deviation at base of pitch to allow use of rope
as lead line - Pitch ~ 5m)

I descended the short boulder slope to the head
of the second pitch, then climbed down the
boulder, rigged from a perched boulder.
(Pitch left unrigged, but with sufficient rope at base
end of lead line for it to be rigged - on the
last trip we tried bolting, but the rock cracked,
leaving a bare naked anchor, which was hammered
to be unusable - Pitch ~ 6m, with further 2m
climb at base into boulder floored chamber.)

On arriving at the base of the entrance pitches,
I waited for Steve. We then carried one of the
ladders into the rift leading off, and added it
to the end of the ladder already rigged on the
previous trip.

(From chamber, rift leads off, follow wide
part of typical Picas ramp to ceiling, after ~
10m. Here a trivial squeeze, requiring the
manoeuvring of bums upwards through the wider part
of the rift leads to the lead of the pitch.)

I climbed down through the English pitch lead,
snagging my alpenes repeatedly, and then descended
to the bottom of the ladder, where I clanked off, onto
a suitable ledge. My initial estimate that the pitch could
need two ladders appeared to be grossly erroneous, I

(29)
was still 8 m above the floor. Steve did the honors of flaking
our final ladder, and adding it to the pitch, this time
it reached the bottom, just.

(The pitch is about 27 m from top to bottom,
we rigged using 3 ladders belayed ~~from~~ with a wire around
a flake about 2 m down the rift. A 30 m rope should
be used instead, as a handline through the top part
of the rift which is constricted, the rebelayed below
the constriction for a main long, probably needing
variations and possibly further rebelays further down.)

Steve joined me - we climbed the inevitable ramp
to the next pit, the water trickling down the bright
rift bench. It looked unclimbable, so we traversed over
it to an unstable boulder floor - description being the
better part of valor. We then decided the pit might
be free climb, and it was. We neared boulders, and
made several drops down into the stream, seeing several
other similar sized inlets coming in. We eventually found
the stream outlet passage, a small crawling/wiggly
passage, which was ~~rather~~ muddy, and needed a
few steps moving; the passage had a moderately
good amount of water in it, with a strong in-
draught also. At the end of this section of crawl
we came to a pitfall trap we could not descend.

(From the base of the main 30 m pitch, climb
along the rift for about 10 m to a pit in the floor.
Suggest continue rope above as handline to the pit,
then rig for S.R.T., probably needing variations or
'Y' long - pitch ~ 8 m. At base, carry on along rift,
climbing up rift to point where another inlet met.
Way on is over boulder to left, then climb down 10 m
through rift & boulders to small chamber (- Adjacent chamber
may be accurately climbed into - by recognizable as